

# DCR-RF949-2.8(O)

## OUTDOOR IR-BOX HD-SDI CAMERA



### Main Features

- 1/2.8" Sony 2.9μm Pixel Sony Starvis Color CMOS Sensor
- 2Mega Pixels (Max. 1080p50/60)
- f=2.8mm MP Lens
- 24pcs of 850nm IR LEDs
- Analog Composite Video Out Available
- Flexible Installation: U type swivel bracket can hold up the camera both up & down or left & right.
- Water-proof Housing (IP66)



### Dimension

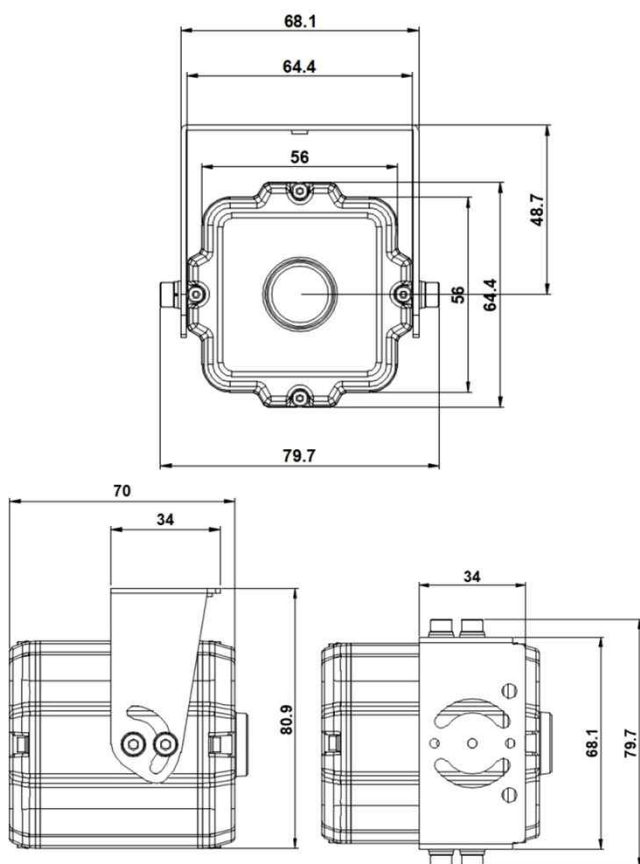

### Option

- Lens (f=3.3, 3.6, 4, 6, 8, 12, 16, 25mm)

### Specifications

Model	DCR-RF949-2.8	DCR-RF949-2.8O
Signal System	3G-SDI (Serial Digital Interface)	
Pickup Device	1/2.8"(D-6.46mm) 2.12M Sony CMOS Sensor	
Scanning System	Progressive Scan (16:9)	
Sync. System	Internal	
Total Pixels	2.16MP [1,945(H)x1,109(V)]	
Active Pixels	2.12MP [1,937(H)x1,097(V)]	
Min. Illumination	0.01Lux(F2.5 - 30IRE), 0lux(IR on)	
No. of IRED	24ea (850nm)	
Video Out 1 (BNC)	HD-SDI: 1080p25/30, 720p25/30, 720p50/60, 1080i50/60 EX-SDI: 1080p25/30/50/60, 720p25/30/50/60, 1080i50/60	
Video Out 2 (BNC)	Analog CVBS or AHD, TVI, CVI AHD, TVI and CVI: 1080p@25/30 / Analog CVBS: D1	
Lens	ICR f=2.8mm, F2.5	
Lens (Mount)	Board type (M12)	
Angle of View	123.5°(D), 104°(H), 59°(V)	
OSD	N/A	OSD Cable
Camera Title	Off, On(Max. 8 Characters)	
Language	English, Chinese(Simplified), Chinese(Traditional), Japanese, Korean	
Exposure	ELC (Manual)	
White Balance	AWB, ATW, Push Lock, Manual	
BLC	Off, HLC, BLC, WDR	
Day & Night Mode	AUTO, COLOR, B/W, EXT	
Gain Control	AGC (0~10)	
Electronic Shutter	1/25(30)~1/25,600(30,000)sec	
Noise Reduction	3DNR (Off, Low, Middle, High)	
DSS(Sens-up)	X32	
Mirror	Off, On(Mirror, Flip, Rotation)	
Other Features	Motion Detection (4 Zones), Privacy Mask (16 Zones), ACE, D-Zoom, Defog, Gamma, Shading etc.	
Communication	N/A	
Power Source	DC12V	
Power Consumption	Less than 4 Watts (330mA)	
Operating Temp.	-10℃ ~ 55℃ (Humidity :0%RH ~ 90%RH)	
Size (mm)	64.4(W) x 64.4(H) x 70(D) (Without Bracket)	
Weight	377g (Giftbox Packing)	389g (Giftbox Packing)

# Cable Connection Interface

## DCR-RF949-2.8

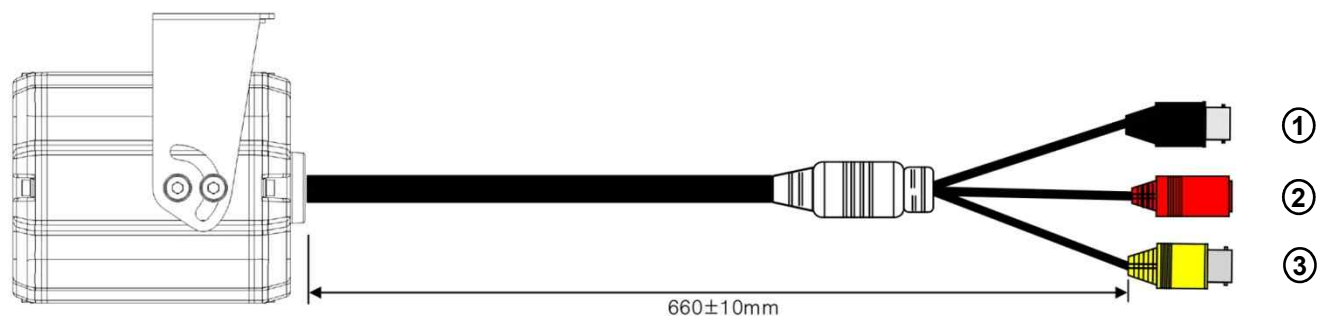

## DCR-RF949-2.80

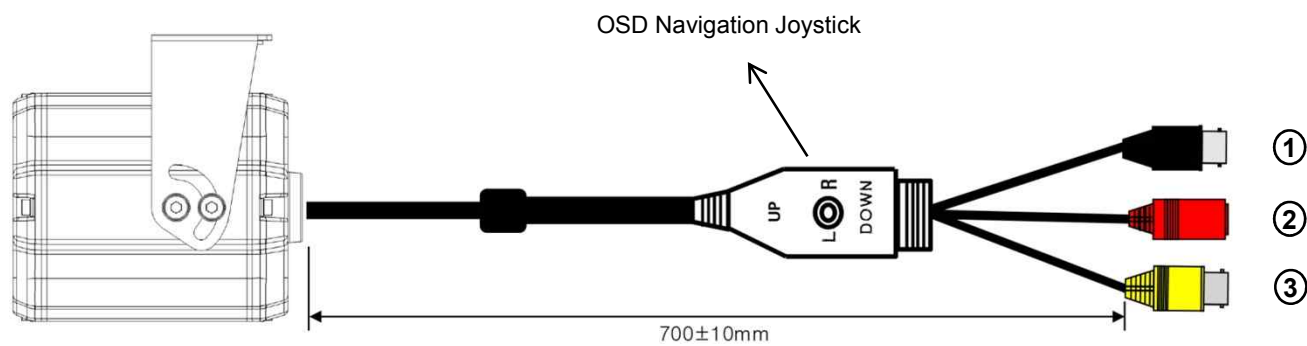

	Function	I/O	Note	Remarks
①	VIDEO	OUT	Digital SDI VIDEO	
②	POWER	IN	DC POWER INPUT	DC12V
③	VIDEO	OUT	Analog CVBS VIDEO	

SETUP MENU	SUB MENU 1	SUB MENU 2	SUB MENU 3	VALUE
LENS				MANUAL / <b>DC</b>
ZOOM/FOCUS	FOCUS MODE			<b>ONESHOT</b> / MANUAL
	D&N FILTER			<b>SYNC OFF</b> / SYNC ON
	ONEPUSH AF			Press ENTER Key
	LENS RESET			Press ENTER Key
EXPOSURE	BRIGHTNESS			0 ~ 20 <b>(10)</b>
	SHUTTER	<b>AUTO</b>	Lens Mode DC	INDOOR / <b>OUTDOOR</b> / DEBLUR
			Lens Mode Manual	NORMAL/DEBLUR
	MANUAL			NTSC : 1/30,60,120,250,500,1K,2K,4K,8K,15K,30K PAL : 1/25,50,100,200,400,800,1.6K,3.2K,6.4K,12.8K,25.6K
	SENS-UP			<b>OFF</b> / X2/ X4/ X8 / X16 / X32
	AGC			0 ~ 10 <b>(8)</b>
BACKLIGHT	<b>OFF</b>			
	HLC	LEVEL		0 ~ 20 <b>(10)</b>
		COLOR		<b>BLK</b> ,WHT,YEL,CYN,GRN,MAG,RED,BLU
	BLC	H-POS		0 ~ 20 <b>(6)</b>
		V-POS		0 ~ 20 <b>(5)</b>
		H-SIZE		0 ~ 20 <b>(7)</b>
		V-SIZE		0 ~ 20 <b>(7)</b>
	WDR	WEIGHT		LOW/ <b>MIDDLE</b> / HIGH
DAY&NIGHT	AUTO	D>N THRES		0(bright) ~ 20(dark) <b>(6)</b>
		N>D THRES		0(bright) ~ 20(dark) <b>(8)</b>
		DELAY		0 ~ 9sec, 10sec, 15sec <b>(0 Sec)</b>
		BURST		OFF/ <b>ON</b>
	COLOR			
	B&W	BURST		OFF/ <b>ON</b>
	<b>EXT. D&amp;N</b>	SMART IR		<b>OFF</b> /ON
		SAT. LEVEL		0 ~ 20 <b>(10)</b>
		EXTERN SW		HIGH/ <b>LOW</b>
		DELAY		0 ~ 9sec, 10sec, 15sec <b>(0sec)</b>
		BURST		OFF/ <b>ON</b>
WHITE BAL	AWB	<b>AUTO</b>		
		AUTOext		
		PRESET		Press ENTER key
		MANUAL	C-TEMP.	3000K/ <b>5000K</b> / 8000K
			R-GAIN	0 ~ 20 <b>(10)</b>
			B-GAIN	0 ~ 20 <b>(10)</b>
	COLOR GAIN			0 ~ 20 <b>(10)</b>
DNR				OFF/ LOW/ <b>MIDDLE</b> / HIGH
IMAGE	SHARPNESS			0 ~ 10 <b>(8)</b>
	GAMMA			0.45/ <b>0.55</b> / 0.65/ 0.75
	MIRROR			<b>OFF</b> /ON
	FLIP			<b>OFF</b> /ON
	D-ZOOM			1.0X~16.0X <b>(1.0X)</b>
	ACE			<b>OFF</b> /LOW/ MIDDLE/ HIGH

SETUP MENU	SUB MENU 1	SUB MENU 2	SUB MENU 3	VALUE
IMAGE	DEFOG	<b>OFF</b>		
		ON	MODE	<b>AUTO</b> /MANUAL
			LEVEL	LOW/ <b>MIDDLE</b> / HIGH
	SHADING	<b>OFF</b>		
		ON	WEIGHT	0~100% <b>(100%)</b>
	PRIVACY	BOX	<b>OFF</b> /ON	
			ZONE NUM	0~15
			ZONE DISP	OFF/ON
			H-POS	0~60
			V-POS	0~34
			H-SIZE	0~60
			V-SIZE	0~34
			Y LEVEL	0~20
			CB LEVEL	0~20
			CR LEVEL	0~20
			TRANS	0~3
		POLYGON	<b>OFF</b> /ON	
			ZONE NUM	0~7
			ZONE DISP	OFF/ON
			POS0-X ~POS3-X	0~120
			POS0-Y~POS3-Y	0~68
			Y LEVEL	0~20
			CB LEVEL	0~20
			CR LEVEL	0~20
			TRANS	0~3
MOTION	<b>OFF</b>			
	ON	DET WINDOW	WINDOW USE	0~3
			WINDOW ZONE	OFF/ON
			DET H-POS	0~60
			DET V-POS	0~34
			DET H-SIZE	0~60
			DET V-SIZE	0~34
		SENSITIVITY		0~10 <b>(5)</b>
		MOTION OSD		<b>OFF</b> /ON
		TEXT ALARM		<b>OFF</b> /ON
		SIGNAL OUT		OFF/ <b>ON</b>
SYSTEM	COMM	CAM ID		0 ~ 255 <b>(1)</b>
		BAUDRATE		2400,4800, <b>9600</b> ,57600,115200
		CAM ID DISPLAY		<b>OFF</b> /ON
	OUTPUT	FRAME RATE		<b>1080_30p(25p)</b>
		FREQ		50Hz(PAL) / 60Hz(NTSC)
		ANALOG MODE		OFF / <b>CVBS</b> / HD_T / HD_C / HD_A
		CVBS OUT MODE		CUT / <b>FULL</b>
	LANGUAGE			<b>ENG</b> / CHINESE/ CHINESE(S)/ JAPANESE/ KOR
	CAM TITLE	<b>OFF</b>		
		RIGHT UP		0 ~ 9, A ~ Z, blank
		LEFT DOWN		0 ~ 9, A ~ Z, blank
FACTORY DEFAULT				Reset to factory setting
EXIT				Exit SETUP menu