

# DCR-NF9469-2.8

## OUTDOOR IR-BOX 3G-SDI CAMERA



### Main Features

- 1/2.8" Sony 2.9μm Pixel Sony Starvis Color CMOS Sensor
- 2Mega Pixels (Max. 1080p50/60)
- f=2.8mm MP Lens
- 24pcs of 940nm IR LEDs
- OSD Not Supported
- Analog Composite Video Out Available
- Flexible Installation: U type swivel bracket can hold up the camera both up & down or left & right.
- Water-proof Housing (IP66)



### Dimension

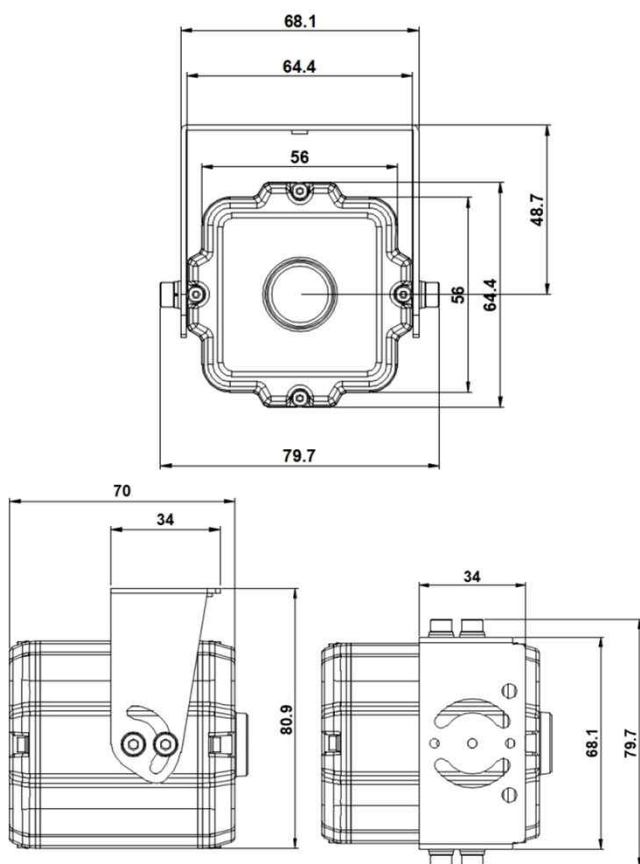

### Option

- Lens (f=3.3, 3.6, 4, 6, 8, 12, 16, 25mm)

### Specifications

Model	DCR-NF9469-2.8
Signal System	3G-SDI (Serial Digital Interface)
Pickup Device	<b>1/2.8"(D-6.46mm) 2.12M Sony CMOS Sensor</b>
Scanning System	Progressive Scan (16:9 )
Sync. System	Internal
Total Pixels	2.16MP [1,945(H)x1,109(V)]
Active Pixels	2.12MP [1,937(H)x1,097(V)]
Min. Illumination	<b>0.01Lux(F2.5 - 30IRE)</b> , 0lux(IR on)
TDN	N/A
Video Out 1 (BNC)	3G-SDI: 1080p50/60
Video Out 2 (BNC)	Analog CVBS
Lens	<b>f=2.8mm, F2.5</b>
Lens (Mount)	Board type (M12)
Angle of View	<b>123.5°(D), 104°(H), 59°(V)</b>
OSD	N/A
Camera Title	N/A
Language	N/A
Exposure	ELC
White Balance	AUTO
BLC	Off
Day & Night Mode	AUTO
Gain Control	AGC (0~10)
Electronic Shutter	1/25(30)~1/25,600(30,000)sec
Noise Reduction	<b>3DNR (Middle)</b>
DSS(Sens-up)	Off
Mirror	Off
Other Features	N/A
Communication	N/A
No. of Camera ID	N/A
Power Source	DC12V
Power Consumption	Less than 3.9 Watts (320mA)
Operating Temp.	-10℃ ~ 55℃ (Humidity :0%RH ~ 90%RH)
Size (mm)	64.4(W) x 64.4(H) x 70(D) (Without Bracket)
Weight	377g (Giftbox Packing)