

DUM-F1S0-2.8(JP)

USB2.0 MINIATURE CAMERA



Main Features

- 1/2.8" 2.9μm Pixel Progressive Sony Starvis CMOS Sensor
- 2 Mega Pixels – Maximum 1080p (1920x1080)
- Fixed Board Lens (f=2.8mm)
- USB2.0 Compliant
- Best for ATM, Kiosk, POS, Face Recognition, Gaming Applications
- Box Miniature Housing(30x30 type)
- Providing 3M long USB cable & U type swivel bracket



Dimension

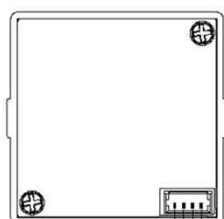
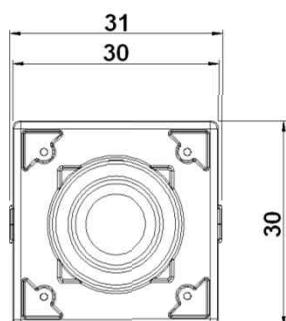

DC5V
DM
DP
GND

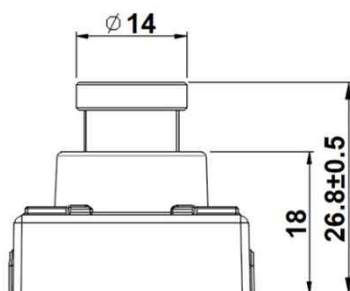

Option

- Lens
f=1.1(fish-eye), 1.7, 2.1, 2.5, 3.3, 3.6, 4, 6, 8, 12, 16, 25mm
- Cable: 70cm
- Tripod on Rear Plate: DUM-F1S0-2.8
- USB3.0 (YUV Output): DUM-F1S30-2.8(JP)
- 1080p50/60: DUM-F1S30-2.8(JP)

Specifications

Model	DUM-F1S0-2.8(JP)
Signal System	MJPEG Encoded
Pickup Device	1/2.8"(D-6.46mm) 2.12M Sony CMOS Sensor
Scanning System	Progressive Scan (16:9)
Sync. System	Internal
Total Pixels	2.16MP [1,945(H)x1,109(V)]
Effective Pixels	2.12MP [1,937(H)x1,097(V)]
Min. Illumination	0.1Lux
H-Resolution	More than 1,000TV Lines(H)
Video Out	MJPEG: 1080p(1920x1080)
Capturing Speed	Max. 25/30fps in MJPEG (50/60Hz)
Lens	Fixed f=2.8mm board type, F2.5
Lens (Mount)	Board Mount(M12)
Angle of View	124.5°(D), 105°(H), 59.5°(V)
OSD	N/A
Exposure	Auto
White Balance	Auto
Day & Night Mode	Color (Factory Default)
Gain Control	Auto
Electronic Shutter	Auto
Mirror	Off (Factory Default)
Snap-shot	N/A
Supported O/S	UVC Compatible O/S - Windows, Linux, Mac, Android etc
No. of Camera ID	Up to 2 per PC
Power Source	DC5V via USB
Power Consumption	Less than 0.9 Watts (180mA@DC5V)
Operating Temp.	-10℃ ~ 55℃ (Humidity :0%RH ~ 90%RH)
Size (mm)	30 x 30
Weight	185 g (gift-box packing, Including 3M USB Cable)

Camera Mounting Instruction



- There are three(3) of each Ø3xL8 screw and M2xS/PW4 screw together with a swivel bracket in the accessory package.
- Please use two(2) of the screws as shown above. We are providing one of each extra screw in the package.
- If you do not use M2xS/PW4 screws provided, it can **damage** the camera board inside housing. Such the damage will be your responsibility.