

# AHR-F867-2.8

## AHD3.0 CAMERA FOR VEHICLE



### Main Features

- 1/2.8" 2μm Max. 1944p Sony CMOS Sensor
- 5 Mega Pixels (1944p 20) / 4 Mega Pixels (1440p 25/30)
- Manual Fixed Lens (f=2.8mm)
- 3D-DNR Supported
- Audio Microphone Available (Option)
- UTC Supported
- AHD3.0 Camera (Universal Analog HD Video Formats)
- Wide Operating Voltage Range (DC5~15V)
- Water-proof Housing (IP66)



### Dimension

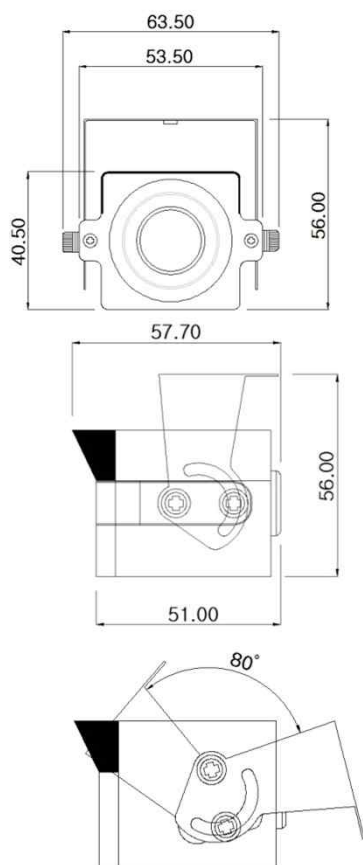

### Option

- Lens(Fixed)  
f=3.6 / 4 / 8 / 12 / 16 / 25mm
- Wall-mount Bracket
- AHR-F867A-2.8 : Audio Built-in, No water-proof

### Specifications

Model	AHR-F867-2.8
Signal System	AHD 3.0
Pickup Device	1/2.8"(D-6.52mm) 5.11M Sony CMOS Sensor
Scanning System	Progressive Scan (5MP Mode - 4:3, 4MP Mode - 16:9)
Sync. System	Internal
Total Pixels	5.69MP [2704(H)x2104(V)]
Active Pixels	5.11MP [2608(H)x1960(V)]
Min. Illumination	1.5Lux(F2.5 - 30IRE)
No. of IRED	N/A
Video Out (BNC)	AHD: 1944p@20 / 1440p@25/30
Lens	Fixed f=2.8mm, F2.5
Lens (Mount)	Board type (M12)
Angle of View	5MP Mode: 120°(D), 93°(H), 67.3°(V) 4MP Mode: 108°(D), 91°(H), 49.4°(V)
OSD	Via UTC
Camera Title	N/A
Language	English, Russian, French, Spanish, Portuguese, German Chinese(Simplified), Chinese(Traditional), Japanese, Italian, Polish, Dutch, Turkish,
Exposure	AE, Manual
White Balance	ATW, AWC
BLC	Off, BLC
Day & Night Mode	AUTO, COLOR, B/W, IR_EXT
Gain Control	AGC (0~20)
Electronic Shutter	1/25(30)~1/25,600(30,000)sec
DSS(Sens-up)	N/A
Noise Reduction	3DNR (High, Middle, Low)
Mirror	Off, On(Mirror, Flip, Both)
Other Features	LSC etc.
Microphone	Option (AHR-F867A-2.8)
Power Source	DC 5~15V
Power Consumption	Less than 1.5 Watts (120mA@DC12V)
Operating Temp.	-10℃ ~ 55℃ (Humidity :0%RH ~ 90%RH)
Size (mm)	63.5(W) x 40.5(H) x 57.7(D) (Without Bracket)
Weight	228g (gift-box packing)

SETUP MENU	SUB MENU1	SUB MENU2	SUB MENU3	SUB MENU4	VALUE
<b>LENS</b>	MANUAL				
<b>EXPOSURE</b>	SHUTTER				AUTO, FLK
	AGC				0 ~ 15
	BRIGHTNESS				1~100
	D-WDR				OFF, AUTO
	BLC	OFF			
		BLC	LEVEL		LOW, MIDDLE, HIGH
			AREA	POSITION	
			DEFAULT	SIZE	
<b>WHITE BALANCE</b>	ATW				
	AWC -> SET				
<b>DAY &amp; NIGHT</b>	COLOR				
	B/W	IR SMART	OFF		
			ON	LEVEL	0~15
	EXT			AREA	
	AUTO	D->N (DELAY)			0~15 SEC
		N->D (DELAY)			0~15 SEC
		D->N (AGC)			1~255
		D->N (DELAY)			0~15 SEC
<b>ADJUST</b>	NR	2DNR			0~15 SEC
		3DNR			0~15 SEC
	SHARPNESS				LOW, MIDDLE, HIGH
	COLOR GAIN	BLUE GAIN			0~10
		RED GAIN			0~10
	LSC				OFF, ON
	MIRROR				OFF, MIRROR, V-FLIP, ROTATE
	DPC	LIVE DPC	AGC LEVEL		0~255
			LEVEL		0~100
		WHITE DPC	POS/SIZE		
			START		
			DPC VIEW		OFF, ON
			LEVEL		0~60
			AGC LEVEL		0~14
	LANGUAGE				ENG, CHN1, CHN2, GER, FRA, ITA, SPA, POL, RUS, POR, NED, TUR, JPN
	OUTPUT MODE	FORMAT			AHD, CHD, THD, CVBS
		RESOLUTION			4MEGA / 5MEGA
		FRAME RATE			RT(Real Time) / NRT(Non-Real Time)
		VIDEO OUT			NTSC / PAL
		APPLY SET			
<b>EXIT</b>	SAVE & END				
	RESET				
	NOT SAVE				