

AHL-SZ940

AHD2.0 LPR CAMERA

PARANTEK



Main Features

- 1/2.8" Sony 2.9μm Pixel Progressive Starvis Color CMOS Sensor
- Approx. 2.12 Mega Pixels (Max. 1080p)
- Stepping 2-Motor Varifocal Lens (ICR f=5~50mm)
- 5pcs of SR-LED & 25pcs of 850nm IR LED
- Max. 15M Recognition Distance (Max. 100Km/h)
- B/W Images for both Day & Night (LED Continuous On)
- WDR / 3D-DNR / DSS (Sens-up) / UTC / OSD Supported
- AHD2.0 Camera (CVBS Out Mode Supported)
- Water-proof IP66 Housing (70Ø)



Dimension

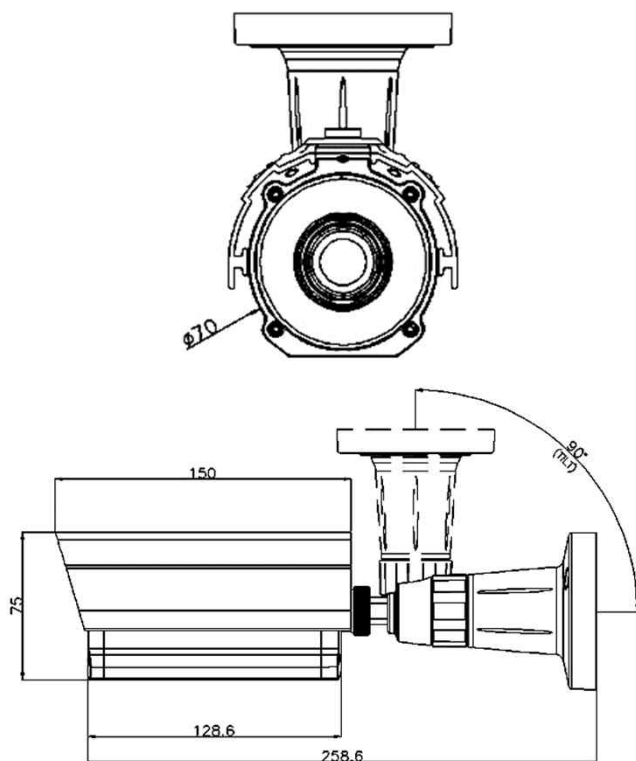

Specifications

Model	AHL-SZ940
Signal System	AHD 2.0
Pickup Device	1/2.8"(D-6.46mm) 2.12M Sony CMOS Sensor
Scanning System	Progressive Scan (16:9)
Sync. System	Internal
Total Pixels	2.16MP [1,945(H)x1,109(V)]
Active Pixels	2.12MP [1,937(H)x1,097(V)]
Min. Illumination	0Lux (Continuous IR on)
No. of IRED	5ea SR-LED and 25ea 5Ø (850nm)
Video Out	AHD, TVI, CVI or Analog CVBS AHD, TVI and CVI: 1080p@25/30 / Analog CVBS: D1
Lens	DC Auto ICR Vari-focal f=5~50mm, F1.6 Stepping Motorized On-push AF
Lens (Mount)	Board type (Ø14)
Angle of View	59.1°~8.7°(D), 50.7°~7.4°(H), 27.7°~4.2°(V)
OSD	Via OSD Switch B/D & UTC
Camera Title	Off, On(Max. 8 Characters)
Language	English, Chinese(Simplified), Chinese(Traditional), Japanese, Korean
Exposure	DC
White Balance	Auto
BLC	Off, HLC, BLC, WDR
Day & Night Mode	B/W
Gain Control	AGC (0~10)
Electronic Shutter	1/4,000(3,200)sec (60Hz/50Hz)
DSS(Sens-up)	N/A
Noise Reduction	3DNR (Off, Low, Middle, High)
Mirror	Off, On(Mirror, Flip, Rotation)
Other Features	Motion Detection (4 Zones), Privacy Mask (16 Zones), ACE, D-Zoom, Defog, Gamma, Shading etc.
Communication	N/A
Microphone	N/A
Power Source	DC 12V
Power Consumption	Less than 9Watts (750mA@DC12V)
Operating Temp.	-10℃ ~ 55℃ (Humidity :0%RH ~ 90%RH)
Size (mm)	70Ø (Bullet Diameter)
Weight	1,213g (Gift-box packing)

Option

- Dual Voltage (DC12V & AC24V)

AHL-SZ940

AHD2.0 LPR CAMERA

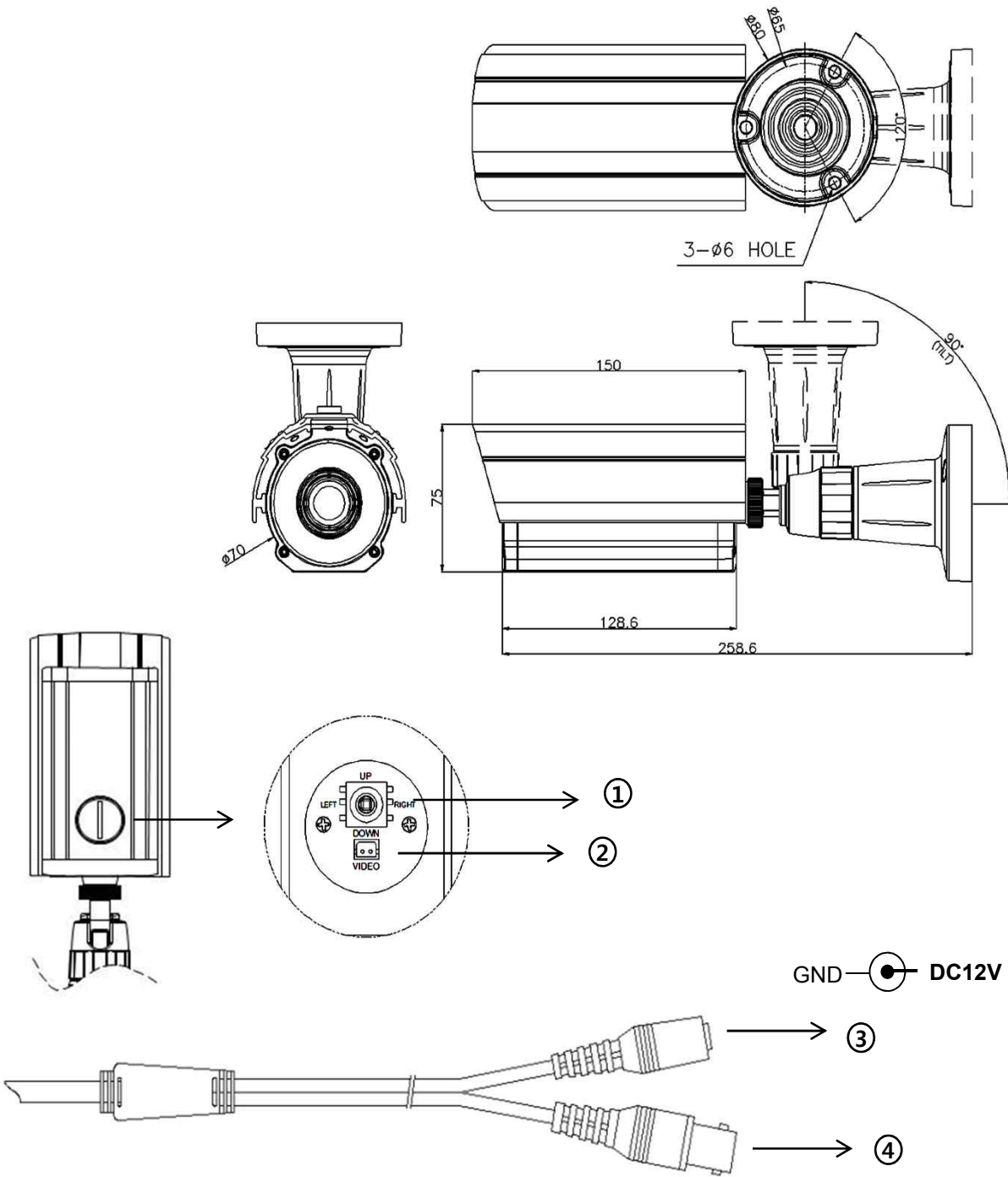

	Function	I/O	Note	Remarks
①	OSD Joystick	N/A	5-directional OSD joystick	
②	VIDEO OUT	OUT	2 nd Video signal output	
③	POWER	IN	Camera power input	DC12V
④	VIDEO OUT	OUT	Video signal output (BNC)	

SETUP MENU	SUB MENU 1	SUB MENU 2	SUB MENU 3	VALUE
LENS				MANUAL / DC
ZOOM/FOCUS	FOCUS MODE			ONESHOT / MANUAL
	D&N FILTER			SYNC OFF / SYNC ON
	ONEPUSH AF			Press ENTER Key
	LENS RESET			Press ENTER Key
EXPOSURE	BRIGHTNESS			0 ~ 20 (10)
	SHUTTER	AUTO	Lens Mode DC	INDOOR / OUTDOOR / DEBLUR
			Lens Mode Manual	NORMAL/DEBLUR
	MANUAL			NTSC : 1/30,60,120,250,500,1K,2K, 4K ,8K,15K,30K PAL : 1/25,50,100,200,400,800,1.6K, 3.2K ,6.4K,12.8K,25.6K
	SENS-UP			OFF / X2/ X4/ X8 / X16 / X32
BACKLIGHT	AGC			0 ~ 10 (0)
	OFF			
	HLC	LEVEL		0 ~ 20 (10)
		COLOR		BLK ,WHT,YEL,CYN,GRN,MAG,RED,BLU
	BLC	H-POS		0 ~ 20 (6)
		V-POS		0 ~ 20 (5)
		H-SIZE		0 ~ 20 (7)
		V-SIZE		0 ~ 20 (7)
DAY&NIGHT	WDR	WEIGHT		LOW/ MIDDLE / HIGH
	AUTO	D>N THRES		0(bright) ~ 20(dark) (6)
		N>D THRES		0(bright) ~ 20(dark) (8)
		DELAY		0 ~ 9sec, 10sec, 15sec (0 Sec)
		BURST		OFF/ ON
	COLOR			
	B&W	BURST		OFF/ ON
	EXT. D&N	SMART IR		OFF /ON
		SAT. LEVEL		0 ~ 20 (10)
		EXTERN SW		HIGH /LOW
		DELAY		0 ~ 9sec, 10sec, 15sec (0sec)
		BURST		OFF/ ON
WHITE BAL	AWB	AUTO		
		AUTOext		
		PRESET		Press ENTER key
		MANUAL	C-TEMP.	3000K/ 5000K / 8000K
			R-GAIN	0 ~ 20 (10)
			B-GAIN	0 ~ 20 (10)
	COLOR GAIN			0 ~ 20 (10)
DNR				OFF/ LOW / MIDDLE/ HIGH
IMAGE	SHARPNESS			0 ~ 10 (8)
	GAMMA			0.45/ 0.55 / 0.65/ 0.75
	MIRROR			OFF /ON
	FLIP			OFF /ON
	D-ZOOM			1.0X~16.0X (1.0X)
	ACE			OFF /LOW/ MIDDLE/ HIGH

SETUP MENU	SUB MENU 1	SUB MENU 2	SUB MENU 3	VALUE
IMAGE	DEFOG	OFF		
		ON	MODE	AUTO /MANUAL
			LEVEL	LOW/ MIDDLE / HIGH
	SHADING	OFF		
		ON	WEIGHT	0~100% (100%)
	PRIVACY	BOX	OFF /ON	
			ZONE NUM	0~15
			ZONE DISP	OFF/ON
			H-POS	0~60
			V-POS	0~34
			H-SIZE	0~60
			V-SIZE	0~34
			Y LEVEL	0~20
			CB LEVEL	0~20
			CR LEVEL	0~20
			TRANS	0~3
		POLYGON	OFF /ON	
			ZONE NUM	0~7
			ZONE DISP	OFF/ON
			POS0-X ~POS3-X	0~120
			POS0-Y~POS3-Y	0~68
			Y LEVEL	0~20
			CB LEVEL	0~20
			CR LEVEL	0~20
			TRANS	0~3
MOTION	OFF			
	ON	DET WINDOW	WINDOW USE	0~3
			WINDOW ZONE	OFF/ON
			DET H-POS	0~60
			DET V-POS	0~34
			DET H-SIZE	0~60
			DET V-SIZE	0~34
		SENSITIVITY		0~10 (5)
		MOTION OSD		OFF /ON
		TEXT ALARM		OFF /ON
		SIGNAL OUT		OFF/ ON
SYSTEM	COMM	CAM ID		0 ~ 255 (1)
		BAUDRATE		2400,4800, 9600 ,57600,115200
		CAM ID DISPLAY		OFF /ON
	OUTPUT	FRAME RATE		1080_30p(25p)
		FREQ		50Hz(PAL) / 60Hz(NTSC)
		ANALOG MODE		OFF / CVBS / HD_T / HD_C / HD_A
		CVBS OUT MODE		CUT / FULL
	LANGUAGE			ENG / CHINESE/ CHINESE(S)/ JAPANESE/ KOR
	CAM TITLE	OFF		
		RIGHT UP		0 ~ 9, A ~ Z, blank
		LEFT DOWN		0 ~ 9, A ~ Z, blank
FACTORY DEFAULT				Reset to factory setting
EXIT				Exit SETUP menu